

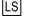

Notes:
 The Queen Elizabeth II Conference Centre states that this plan is for guidance only and does not form any contract, representation or warranty expressed or implied.

Key

-  13 AMP Plug Point
-  Light Switch
-  Telephone/Data
-  TV/FM Point
-  Vent
-  Fire Alarm

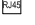
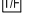
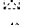

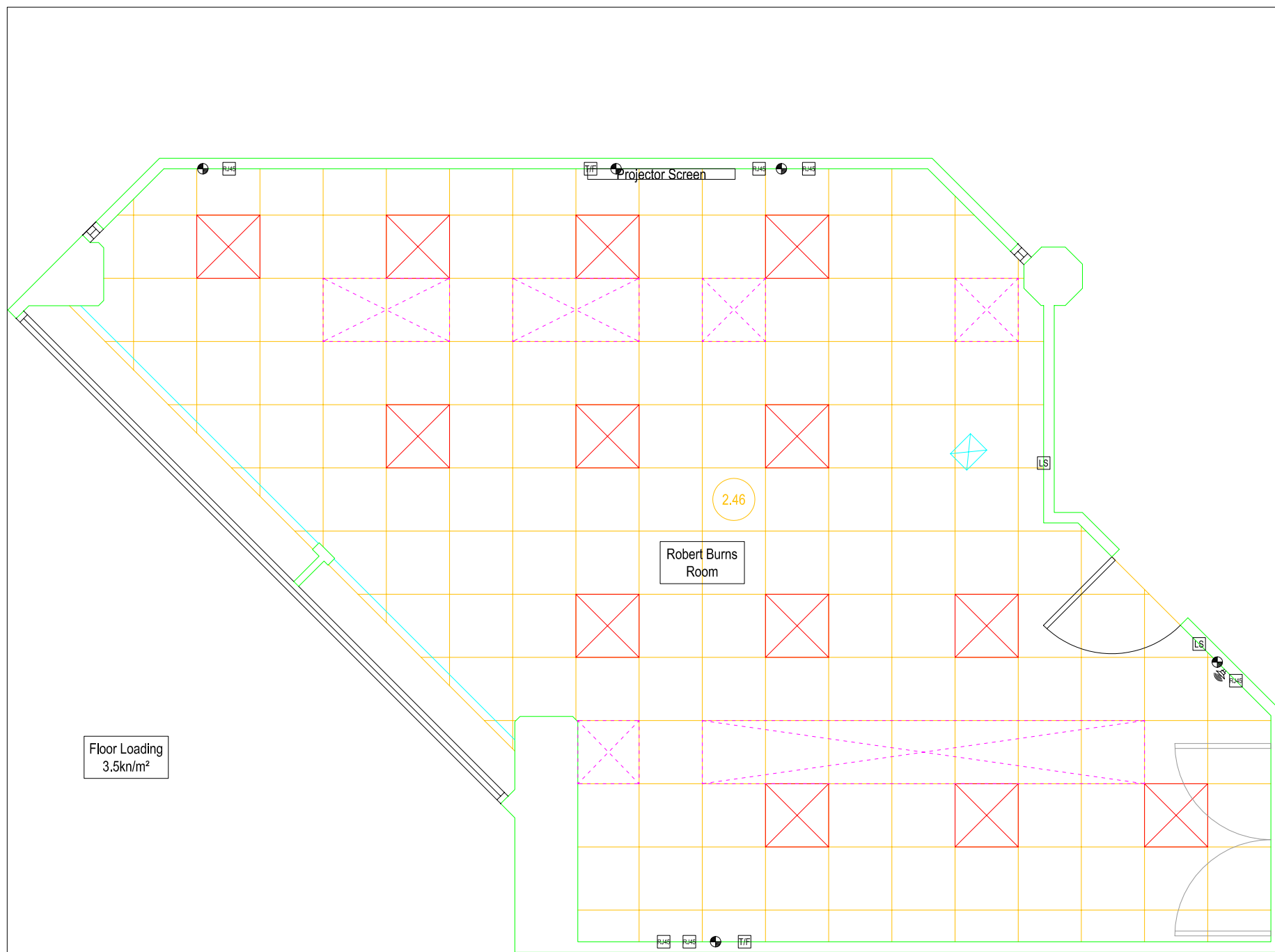
Rev.	Amendment	Date
Site Name: Queen Elizabeth II Conference Centre		
Drawing Title: Robert Burns Room Fourth Floor		
Drawing Number: 4/008		
Scale: 1:50	Date: January 2006	