





Notes:
 The Queen Elizabeth II Conference Centre states that this plan is for guidance only and does not form any contract, representation or warranty expressed or implied.

Key

-  13 AMP Plug Point
-  Light Switch
-  Telephone/Data
-  Vent
-  Fire Alarm

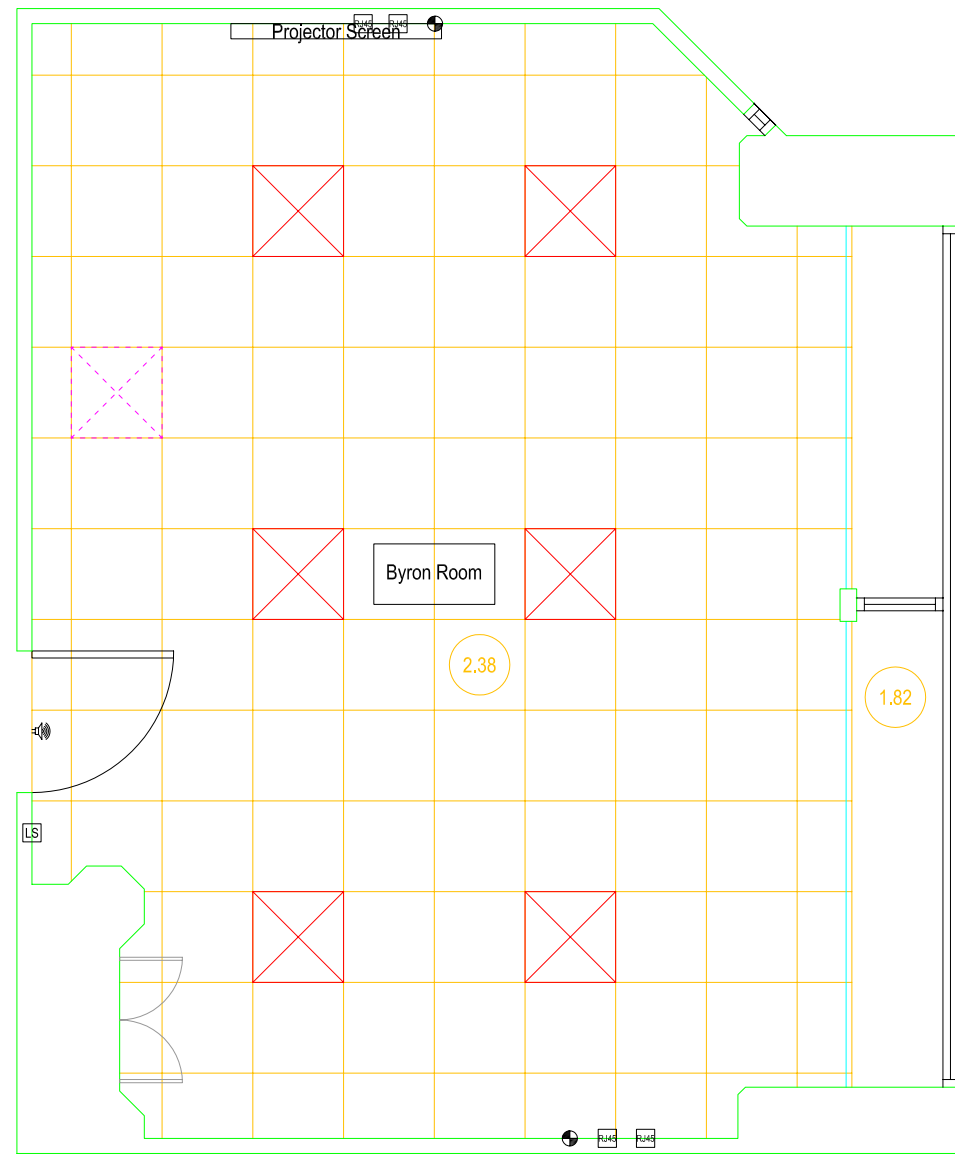

Floor Loading
 3.5kn/m²

| Rev. | Amendment | Date |
|------|-----------|------|
| | | |

Site Name: Queen Elizabeth II Conference Centre

Drawing Title: Byron Room Fourth Floor

Drawing Number: 4/007

Scale: 1:50 Date: January 2006